

## INSTALL Series

### 2 Way Passive Loudspeaker System

## Audio-Performance EK12

The EK12 is a compact two-way passive system that employs a new single AP-12" low frequency driver mounted in a B-6 type vented enclosure. The high frequency unit is a one inch output ferro fluid cooled driver coupled to a 40° / 90°x 60° AP asymmetrical horn. The system incorporates a low loss passive filter designed for flat frequency response and optimal phase alignment. The cabinet is constructed of high quality 12mm plywood and finished with black epoxy paint.

The EK12 comes with a 35mm tube adapter.

Its multi-angle design allows you to use the EK12 in a variety of applications.

By rotating the asymmetrical horn, the EK12 can be configured as front of house or as stage monitor system.

To rotate the horn, simply removed the front grill by removing it's 4x M5 screws, then remove the 4x horn's M5 screws, and put it in one of the four positions. Note that the horn carries a sticker showing the FOH and stage monitor position.

The EK12 and SUB's work together with the AP44M10 or AP48M10 amplifier or the ALC48 digital controller or as a system. The single rack-unit, height channels digital controller provides all the basic functions to get the maximum performance from the system.

## DESIGNED FOR

Front of house  
or  
Stage monitor  
system

KTV  
Concert halls  
Clubs  
Discotheques  
Theatres

## Special Features



Asymmetrical horn

high efficiency

low distortion

processor controlled

INSTALL Series

**EK12 Specifications**

**ACOUSTICAL**

Frequency response (1).....	50Hz - 20KHz
Phase response .....	350Hz - 10Khz + / - 45°
Max. peak SPL (2).....	133dB
Coverage .....	Horizontal: 60°
	Vertical: 90° to 40°, four position
Crossover Frequency .....	1100Hz
Power handling .....	500W (AES) (4)

**TRANSDUCERS**

Low frequency .....	1 x 12 inch neodymium, long excursion low distortion cone driver
High frequency .....	1 x 2 inch diaphragm, neodymium compression driver, loaded with asymmetrical horn
Nominal impedance .....	8 Ohms
Connectors .....	2 x Neutrik Speakon, model NL4MP (wired in parallel)
	1+: SP+, 1-: SP-, 2+, 2-: linked

**MECHANICAL**

Enclosure shape .....	Multipurpose FOH or Floor monitor
Enclosure .....	12 / 15mm plywood
Finish .....	Black epoxy painted
Dimensions (W x H x D) .....	360 x 694 x 394mm
Grill .....	Hexagonal perforated 1.6mm steel grill covered with charcoal grey foam.
Weight .....	22Kg
Rigging .....	11x M8 Screws
Mounting system .....	one 35mm K&M tube stand adapter

The coverage pattern of the asymmetricalhorn. Vertically 60° and horizontally smoothly changing from 90° to 40°

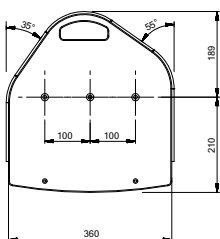
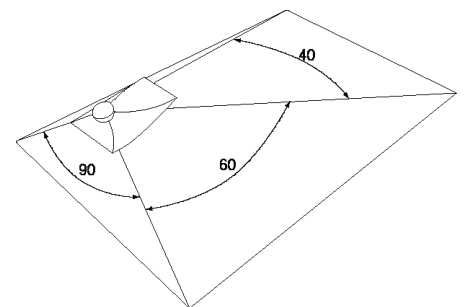
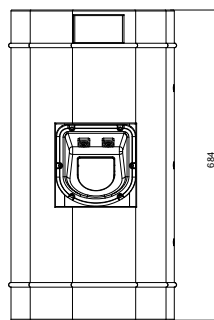
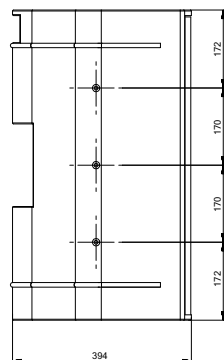
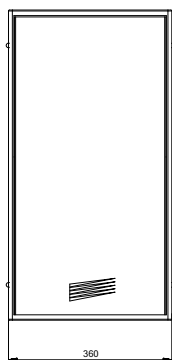

**Low Profil Stage Monitor**

