

MULTI MEDIA Series

Ultra Compact, 2Way passive or self-powered system

Audio-Performance RubiQ

AUDIO
PERFORMANCE
power to perform

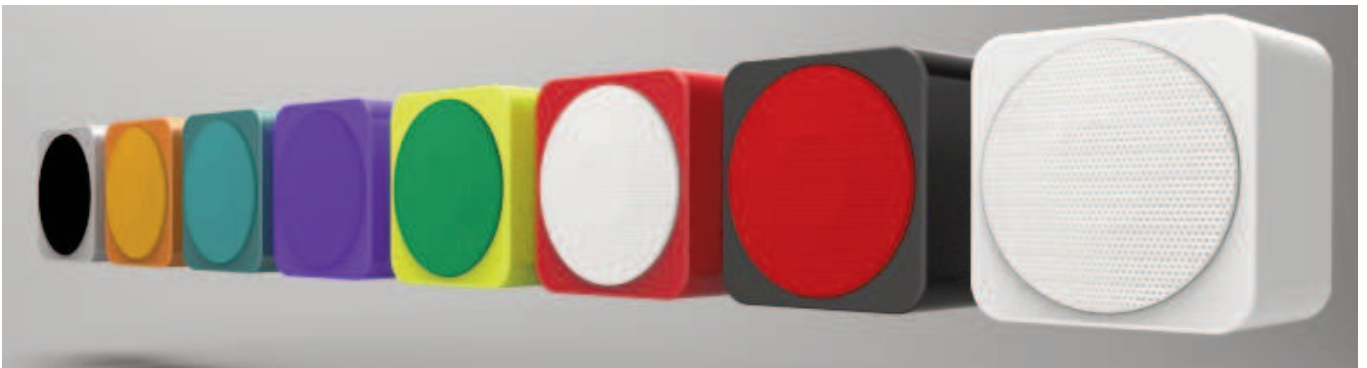

Passive or Self-Powered, RubiQ System is an ultra compact 2Way System composed of one SUB28 Band-Pass Subwoofer and four Qube3 satellites. RubiQ System is design to operate in small to medium size indoor installation requiring high quality sound and stylish design.

The SUB28 Subwoofer consists of two long excursion 8" cone driver mounted in a proprietary isobaric band-pass enclosure.

The Qube3 consists of one 3" full range cone driver mounted in a wood fashion enclosure.

To perfectly much with a wide variety of decors, RubiQ System is available in white, black or any custom colour as an option. The grill and the housing could be painted in different colours to perfectly match customers requests.

RubiQ can play with two Qube3 only and the System can be ordered in two or four Qube3 configuration.

One RubiQ self-powered can drive one more passive RubiQ creating an attractive solution for music playback application in Bars, Hotels & Shops.

IDEAL FOR

Restaurants
Bars
Hotels, Shops
Theatre
Home Hi-Fi



KEY FEATURES

Hi-Fi Sound Quality

Fashion Design

Passive or
Self-Powered

Available in any colours

MULTI MEDIA Series

RubiQ Specifications

ACOUSTICAL

Frequency response (1)	42Hz - 22'000Hz + / - 3dB (SUB28: 42 - 180Hz; Qube3: 180 - 22'000Hz)
Phase response	350Hz - 10KHz + / - 45°
Maximum peak SPL (2)	118dB
Coverage	Horizontal: 100°

TRANSDUCERS

SUB28	2 x 8" long excursion, low distortion cone driver
Nominal impedance	2 x 8 Ohms
Power Handling	120W RMS (AES) (4)
Qube3	1 x 3,5" full range cone driver
Nominal impedance	8 Ohms
Power Handling	30W RMS (AES) (4)

MECHANICAL

SUB28 size (WxHxD)	252 x 450 x 500 mm
Cabinet finish	15 mm plywood, any colours
Weight	17 Kg
Qube3 size (WxHxD)	110 x 110 x 80 mm
Cabinet finish	15 mm plywood, any colours
Weight	0.8 Kg

AMPLIFIER MODULE

Total output power	760W RMS SUB28: 2 x 190W Class D Qube3: 2 x 190W Class D
Audio input	Type: Analogue differential balanced input circuit, Nominal impedance: 10K Ohms Connectors: 2 x XLR female (L / R) XLR wiring: 1= GND, 2= Hot, 3= Cold
DSP	Resolution: 24bit / 96KHz Dynamic range 113dB
AC power	Connector: IEC Main connector Input Voltage: 115 - 250V nominal + / - 10% Input voltage selection: Automatic

OPTION

Mounting bracket for wall and ceiling. Audio Performance W100 Black or White (not included)
100V Line Transformers

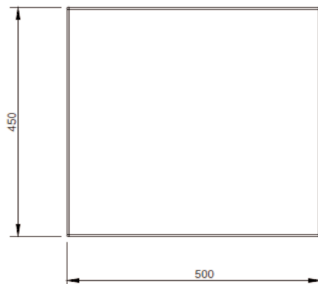
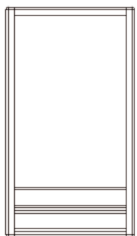

SUB28

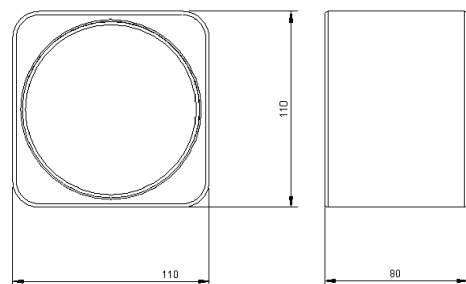

Qube3



W100 White